



TUDOR VILLAGE, VIGILANCE DRIVE, KNYSNA
P.O. BOX 1365, KNYSNA, 6570
TEL: (044) 302 4500 FAX: (044) 382 5424

<http://www.tandbgroup.co.za>

S.A. PATENT 90/9989

Warning
This drawing is the property of T&B Log Homes and may not be copied, issued or used for any purpose other than what it has been issued for without the consent of T&B Log Homes

Please note:
All dimensions and levels to be verified on site prior to commencing work. Only figured dimensions to be used, drawings are not to be scaled.

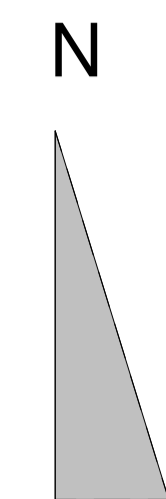

Existing dry-stone wall to be rehabilitated through course of project Phases

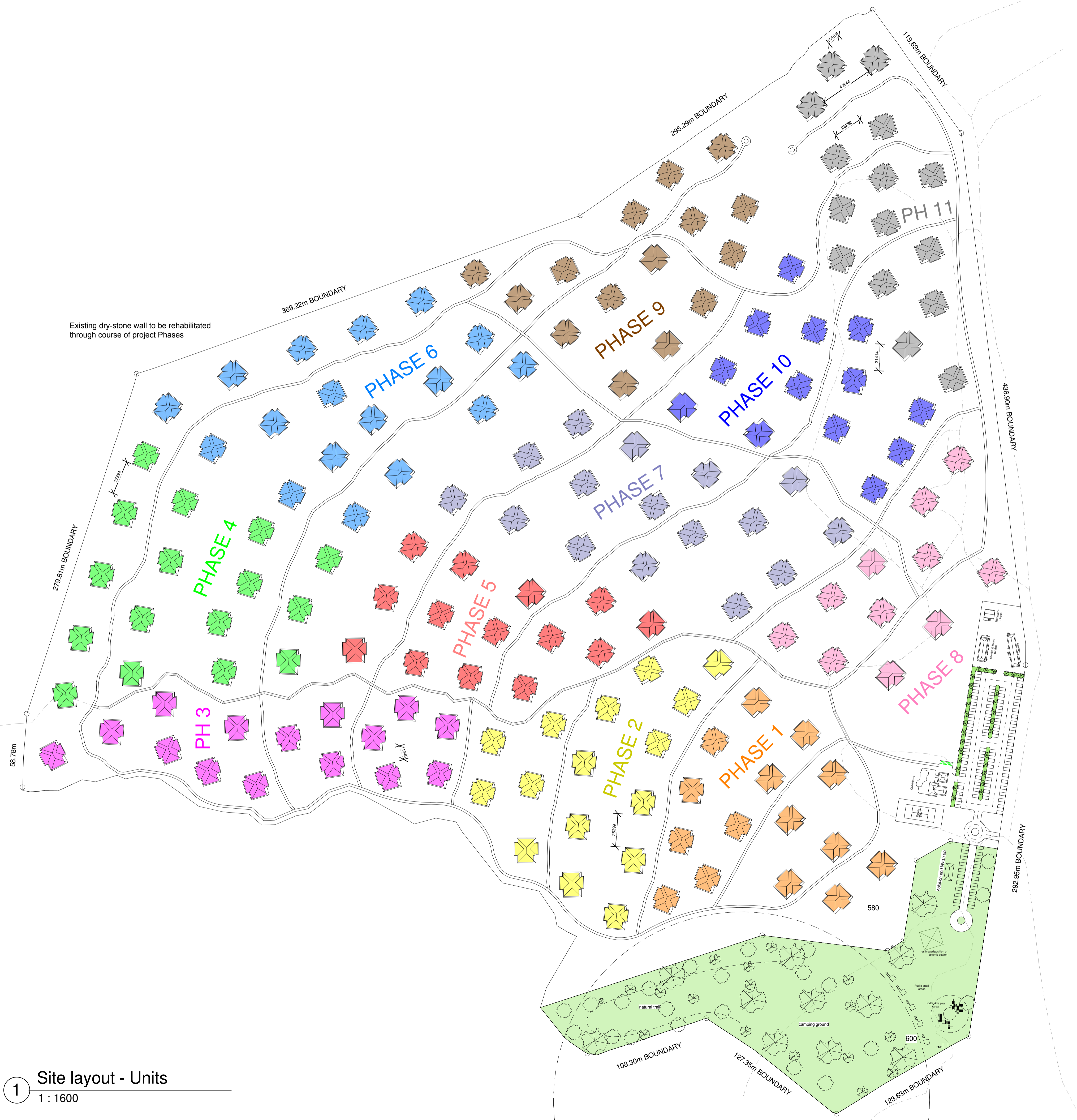

NOTE:
Subject to sales - may be type A (shown), B, C or D

Total units: 150
Club House Parking: 150
Public picnic Parking: 40

UNITS PHASING

- PHASE 1 - 15 units
- PHASE 2 - 16 units
- PHASE 3 - 15 units
- PHASE 4 - 16 units
- PHASE 5 - 14 units
- PHASE 6 - 17 units
- PHASE 7 - 16 units
- PHASE 8 - 11 units
- PHASE 9 - 15 units
- PHASE 10 - 13 units
- PHASE 11 - 15 units

- EXISTING SERVICE ROADS - to be used as service & cart roads
- SERVICE & CART ROADS - NEW
- GOLF CART ONLY ROADS - NEW

No.	Description	Date
1	Phasing changed	01.08.2018
2	Changes by client: Project rename ; Omit public buildings ; Add club house ; Public picnic area ; 50 more housing units ; Amend road width to fit golf carts ; Add golf cart parking to each unit ; Add 4 bedroom unit	15.05.2019
3	Revision - Changes requested by client	20.05.2019
4	Revision - 150m diameter changes requested by client	10.09.2019
5	Revision - changes by client & add of Public extract plan	13.09.2019
6	Revision - changes by client	18.09.2019
7	Note added, as per Client	6.04.2020



SOUL AGENTS
South Africa: girgina.debeer@shcplc.com
Tel: +27 76 991 1666
St Helena: ngcph@helanta.co.sh
Tel: +290 61198

PROJECT
Site Layout
FOR
Trade Winds Ocean Village
IN
St Helena Island
Site Layout

Project number T1827

Date 06.04.2020

Drawn by KB

Checked by DS

Sheet No. A000

Scale 1 : 1600

1 Site layout - Units
1 : 1600